



World Class Clampseal[®] Strainers

The CLAMPSEAL design is available in a variety of in line Y strainer configurations. Supplied as either a simple strainer with blowoff socket connection or strainer with integral blowoff valve, the CLAMPSEAL is easily disassembled for element cleaning or changeout. The CLAMPSEAL offers a versatile, economical alternative for strainer requirements. Blowoff bonnet enables use of any CLAMPSEAL valve as a flush point.

CLAMPSEAL Strainer Specifications:

Size: 1/2" 4"
Class: 600 3500
Material: SA 105, SA 182 F22, SA 182 F91, SA 182 F316
Standard strainer element hole sizes: 1/32, 3/64, 1/16, 3/32, 1/8
Options: mesh lined strainer elements

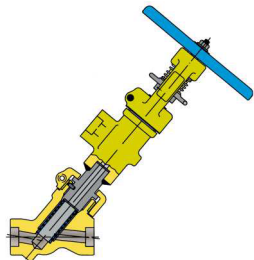
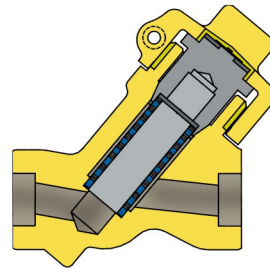

CLAMPSEAL Strainer with Blowoff Valve Specifications:

Size: 1/2" 4"
Class: 600 3500
Material: SA 105, SA 182 F22, SA 182 F91, SA 182 F316
Standard strainer element hole sizes: 1/32, 3/64, 1/16, 3/32, 1/8
Options: mesh lined strainer elements

CLAMPSEAL Strainer with Blowoff Fitting Specifications:

Size: 1/2" 4"
Class: 600 3500
Material: SA 105, SA 182 F22, SA 182 F91, SA 182 F316
Standard strainer element hole sizes: 1/32, 3/64, 1/16, 3/32, 1/8
Options: mesh lined strainer elements

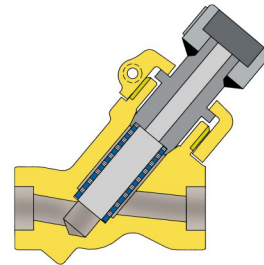

Thank you for your interest in doing business with Conval.
We look forward to being of service.